

How to Fill Out Your Ballot in Six Easy Steps

vote!

An Official Oregon Secretary of State Voter Guide

Your voice matters—make sure it's heard!

Follow these six easy steps to fill out your ballot with confidence.

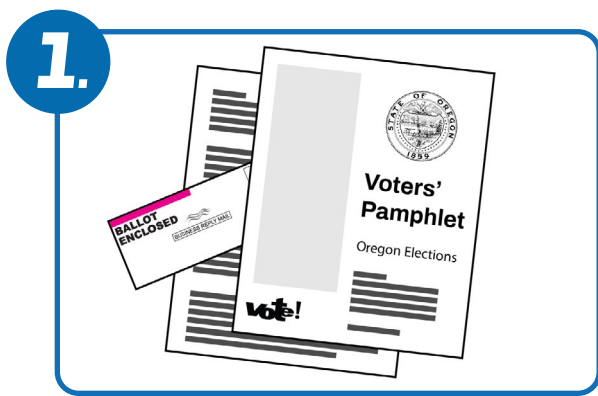

Step 1.

Review the materials included with your ballot

Open your secure ballot envelope and review the materials included with your ballot before you begin.

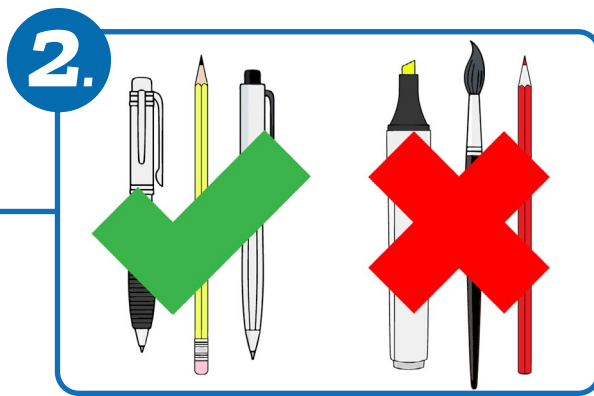

Step 2.

Use the correct writing tool

Use a **black or blue ink** pen or a pencil to mark your ballot. Don't use markers or heavy ink pens, as they may transfer ink to other parts of your ballot. Using the proper writing tool helps ensure your vote is counted accurately.

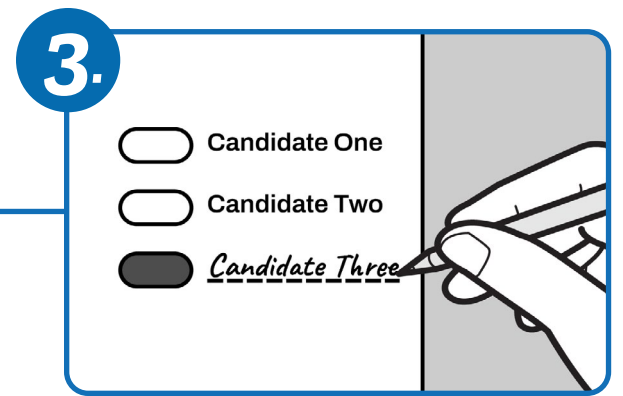

Step 3.

Clearly mark your choices

Review the candidates and measures listed on your ballot. You may wish to consult your voter's pamphlet or other trusted resources before marking your selections. When you're ready, mark your ballot.

You may choose to write-in a candidate name if you don't like the options listed on your ballot—just make sure to write their name clearly.

And remember, you are not required to vote on every candidate or measure listed for your ballot to be counted.

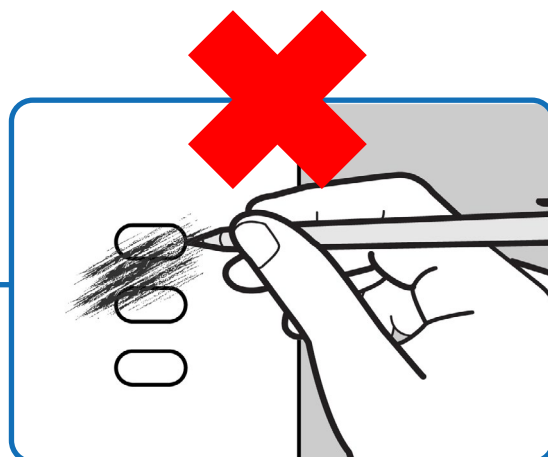
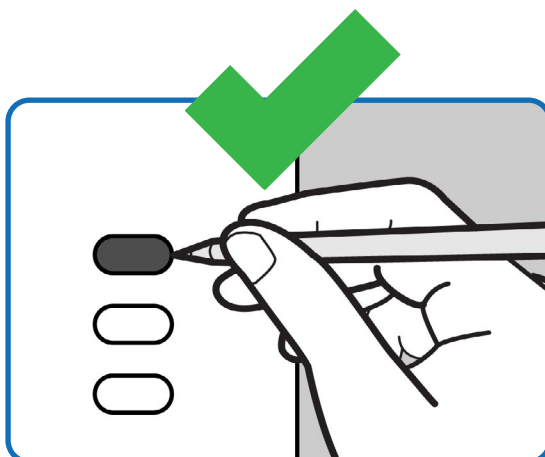

TIP: Make sure your selections are clear and easy to read.

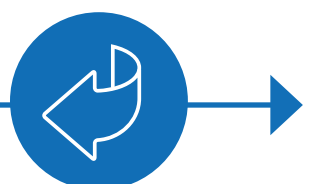



4.



Step 4. Double-check your ballot

Before sealing your ballot, review it carefully:

- Make sure your choices are marked clearly.
- Pay attention to the number of candidates you vote for in each contest, as the number can vary by race.

Made a mistake? Draw an X through the incorrect oval or box, then completely fill in the correct one and make sure your correct selection is obvious.

If an error makes your ballot selections unclear, your ballot was damaged, or you lost your ballot, contact your county elections officials for assistance.

5.

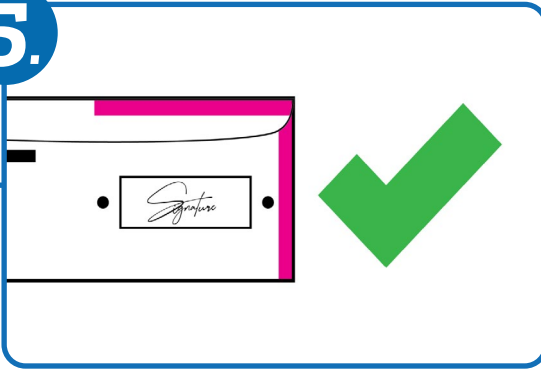

Step 5. Seal and sign your ballot envelope

Place your completed ballot in the provided return envelope and seal it. **Don't forget to sign the envelope!**

Your signature is essential for your ballot to be verified and your vote counted. It should be clear and recognizable as your signature--matching the one on file in your voter registration record, which may include the signature you provided at the DMV.

6.

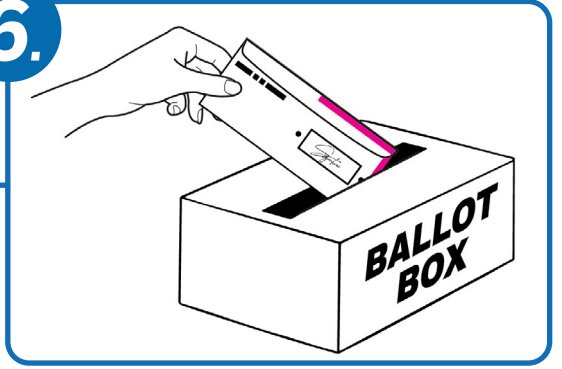

Step 6. Submit your ballot

You're almost done! Now it's time to submit your ballot.

Dropping off your ballot? Visit OregonVotes.gov/dropbox to find the official ballot drop box nearest you. Ballot boxes are available 24/7 during the voting period. You may also choose to hand-deliver your ballot to your county elections office.

Mailing your ballot? Don't wait until the last minute. Mail your ballot as early as possible. Ballots mailed less than seven days before election day may not arrive in time to be counted—especially for voters who live more than 50 miles from the USPS Processing and Distribution Center in Portland.

If you are short on time, consider taking your ballot to a post office near you to request a manual postmark no later than Election Day.

TIP: Four ways to correct a mistake

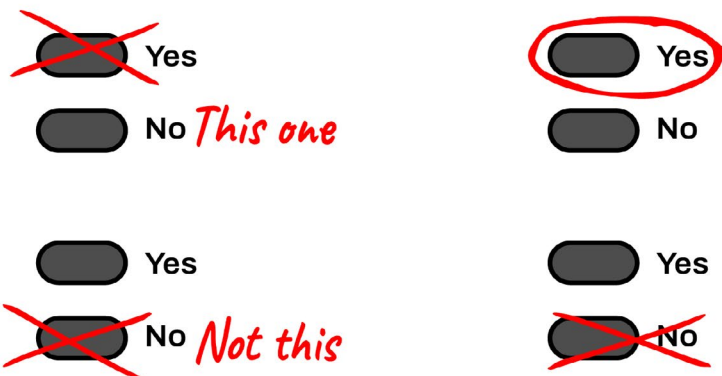

We're here to help!

If you need assistance with marking or returning your ballot for any reason, please call the Oregon Votes toll free information line at 866-673-8683 / TTY 800-735-2900 for the hearing impaired or your county elections office.



To find a drop site near you, visit OregonVotes.gov/dropbox